



FITTING INSTRUCTIONS: PERFECT FIT ROLLER BLINDS

FITTING INSTRUCTIONS: PERFECT FIT ROLLER BLINDS

PLEASE READ THE INSTRUCTIONS BEFORE OPERATING THIS PRODUCT

OPERATION INSTRUCTIONS

TENSION CONTROL

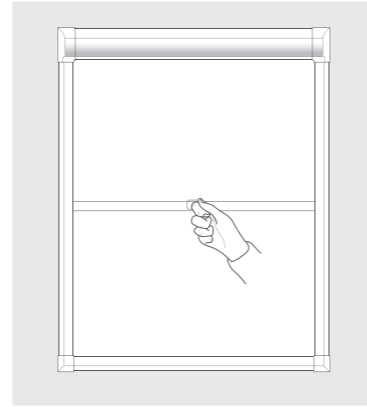

To raise & lower the blind:
Simply raise and lower the blind to the desired position by firmly holding the thumb tab. Rotate the bottom bar to lock it into position

CHAIN CONTROL OPERATION

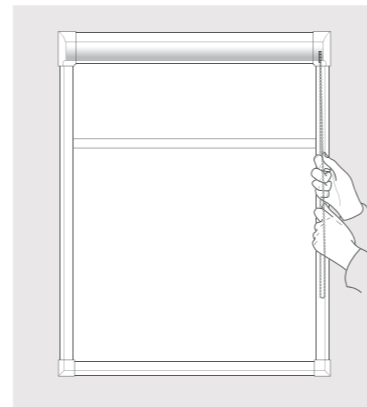

To lower the fabric: Gently pull the operating chain closest to the window.

To raise the fabric: Gently pull the operating chain furthest from the window.

MAINTENANCE

The product is maintenance free however we recommend that regular visual checks are completed to ensure that no components have been damaged, which could result in operating difficulties and/or cause a safety risk.

If any maintenance is required we recommend that the work is carried out immediately, by a reputable blind company.



make it safe



WARNING

Young children can be strangled by loops in pull cords, chains, tapes and inner cords that operate the product.

To avoid strangulation and entanglement, keep cords out of the reach of young children. Cords may become wrapped around a child's neck. Move beds, cots and furniture away from window covering cords.

Do not tie cords together. Make sure cords do not twist and create a loop.

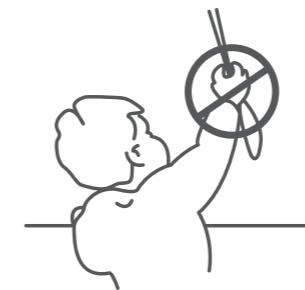

FIT57



PERFECT FIT ROLLER BLINDS

YOU SHOULD HAVE

PERFECT FIT ITEM LIST

Perfect Fit frame and blind

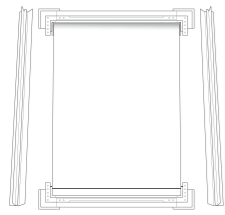

Brackets

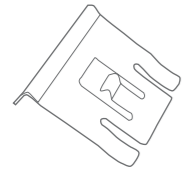

or
Konnect Magnetic Strip

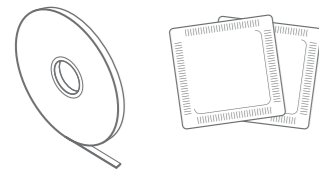

Alcohol Wipe

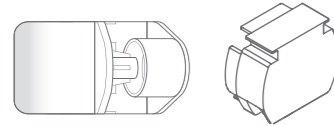

3 x safety device screws
8 x corner connector fixing screws.



TOOLS REQUIRED

Screwdriver

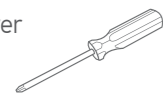

The installation of this product should be conducted by someone competent in DIY.

STEP 1

PUT THE FRAME TOGETHER

1.1
Lay all parts of the frame/blind out face down on a clean even surface. Next unwrap the frame

Your blind will be attached to the top parts of the frame.

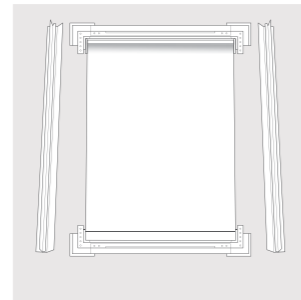

1.2
Connect the left-hand side of the frame to the exposed arm on the bottom left-hand corner joint until it feels secure. Repeat the process on the top left-hand corner joint. Attach the side channels onto the corner connectors at each side of the roller blind by pushing them into place.

Add additional fixing screws if required

Follow the same procedure for the right-hand side of the frame. Attach the side channels onto the corner connectors at each side of the bottom channel by pushing them into place.

Add additional fixing screws if required

Tighten the screws with a screw driver.

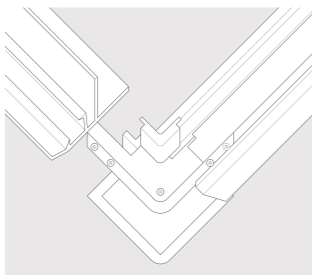

1.3
Your Perfect Fit frame and blind are ready to fit.

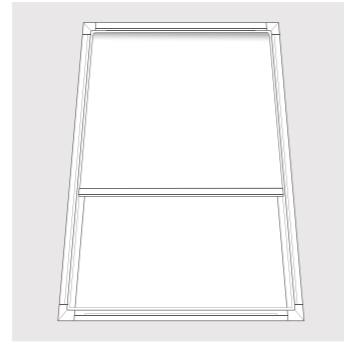

STEP 2 - FITTING OPTION (BRACKETS)

ATTACH THE BRACKETS

2.1
You need to push the brackets between your window pane and the rubber window seal.

The brackets need to be lined up with the bracket hole positions on the Perfect Fit frame.

Brackets are positioned approximately 85mm from the top and bottom.

TIP: Use a bank card to position the brackets.

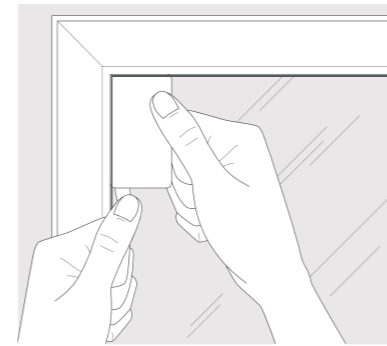

2.2
Fit any intermediate brackets accordingly. Two extra brackets will be supplied for blinds over 110cm drop, these should be positioned approx mid way down the drop of the blind one on each side. Measure the bracket locations from the top of the frame.

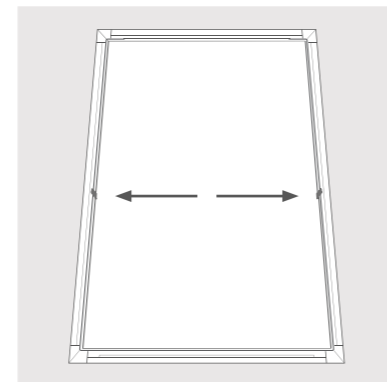

TIP: If you find that the brackets are difficult to place behind the window seal, you can use a some washing up liquid as lubricant on the flat part of the bracket. Once all the brackets are fitted, clean any excess from the window surface.

(KONNECT)

ATTACH THE MAGNETIC STRIP

TIP: Ensure the area where the magnetic strips are applied is clean of dirt and grease. Use a suitable alcohol wipe to clean the surface.

2.1
Remove the paper from one side of the magnetic strip exposing the adhesive layer and position along all 4 sides on the back of the blind frame.

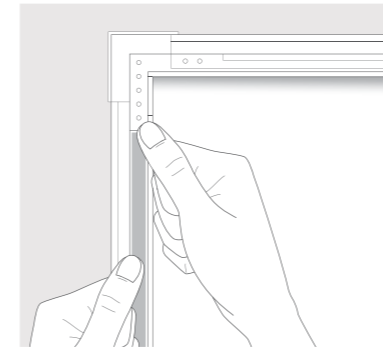

2.2
Remove the remaining paper tape to expose the adhesive layer ready to install the blind.

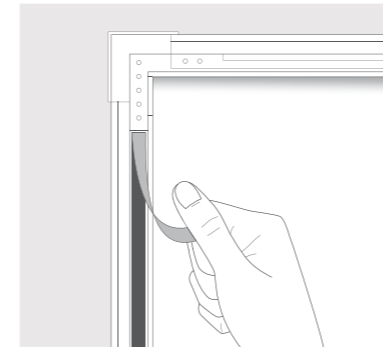

STEP 3 (BRACKETS)

ATTACH THE FRAME & BLIND TO THE WINDOW

3.1
Line up the holes in the Perfect Fit frame with the brackets.

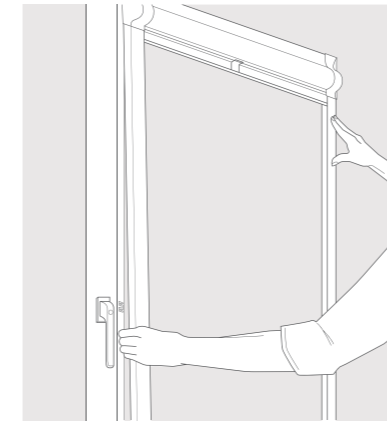

3.2
Firmly press the frame onto each bracket one side at a time.

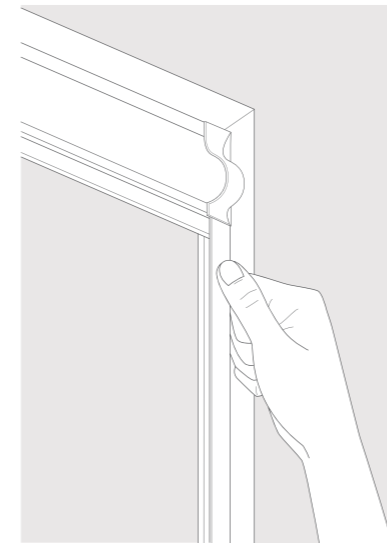

Your frame and blind are now installed.

(KONNECT)

ATTACH THE FRAME & BLIND TO THE WINDOW

TIP: Before applying to the window frame, clean the edges of the window with an alcohol wipe before attaching the blind.

2.1
Line up the Perfect Fit frame with the window and firmly push the frame into position, ensure the Konnect strips are stuck to the window.

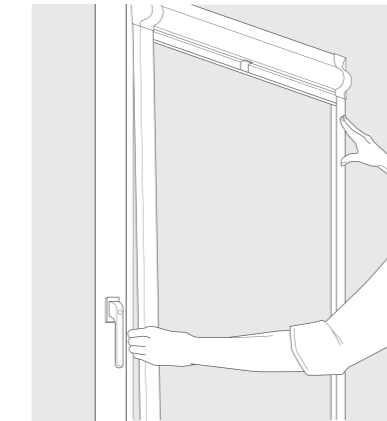

Your frame and blind are now installed.

STEP 4

SAFETY DEVICE (CHAIN CONTROL)

The safety device must be installed at the maximum distance possible from the control mechanism to prevent looped chain becoming slack.

4.1
Slide the cover off the chain tidy. Secure the chain tidy to the predrilled holes on the frame with the screws provided.

Hook the chain over the chain tidy. Slide the cover onto the chaintidy and secure with the provided screw, fit the round cover cap over the screw.

